

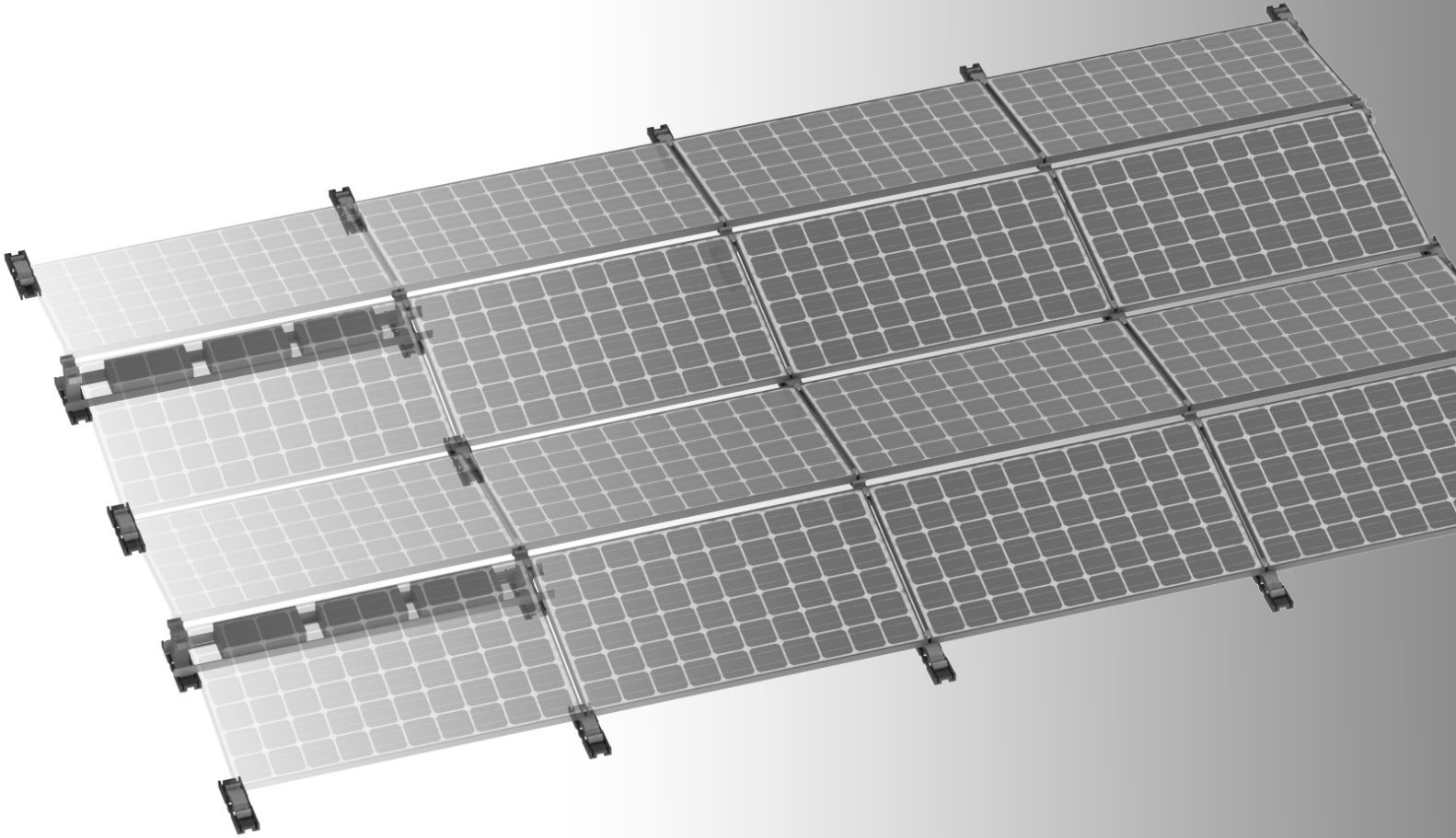

D-Dome Railless² System



- ▶ High quality, German-engineered system optimized for residential installation
- ▶ innovative double-sided low ballast system suitable for all orientations
- ▶ Low component count and fast assembly reduce total installed cost
- ▶ 10° elevation angle
- ▶ High energy density
- ▶ 100% code compliant, structural validation for all solar states
- ▶ Wind tunnel tested by leading structural aerodynamic labs
- ▶ Integrated grounding solution
- ▶ Modular components delivered to the site enable simple, fast installation
- ▶ Reduced freight - it ships in a box



Components



Dome R² Peak

Part Number	Description
4000592	Dome R ² Peak

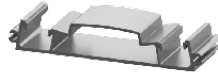

Dome R² Base

Part Number	Description
4000593	Dome R ² Base



Dome R² Roof Protection Mat

Part Number	Description
4000594	Dome R ² Roof Protection Mat



Dome Mid Clamp

Part Number	Description
4000603	DOME MC Silver, SS UL2703+ 30-33mm
4000604	DOME MC Silver, SS UL2703+ 34-39mm
4000605	DOME MC Silver, SS UL2703+ 40-44mm
4000606	DOME MC Silver, SS UL2703+ 45-50mm



Aluminum End Clamp

Part Number	Description
4005344	CrossRail EC Silver, AL 32-33mm
4005169	CrossRail EC Silver, AL 34-36mm
4005290	CrossRail EC Silver, AL 37-38mm
4005170	CrossRail EC Silver, AL 39-41mm
4005291	CrossRail EC Silver, AL 42-44mm
4005171	CrossRail EC Silver, AL 45-47mm
4005292	CrossRail EC Silver, AL 48mm
4005172	CrossRail EC Silver, AL 49-50mm

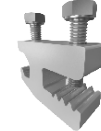

ILSCO Lug

Part Number	Description
4000960	ILSCO, SGB-4, 4-14 SOL-STR



Dome Corner Strut

Part Number	Description
4000637	Dome R ² Corner Strut Kit

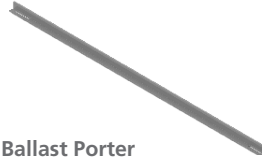

Dome Ballast Porter

Part Number	Description
4000568	Dome R ² Ballast Porter, 61-67in
4000570	Dome R ² Ballast Porter, 74.5-80.5in

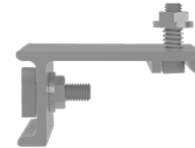

Dome R² Optimizer Kit

Part Number	Description
4000646	Dome R ² Optimizer Mounting Bracket Kit

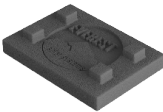

Dome R² Roof Spacer Pad

Part Number	Description
4000636	Dome R ² Roof Spacer Pad