

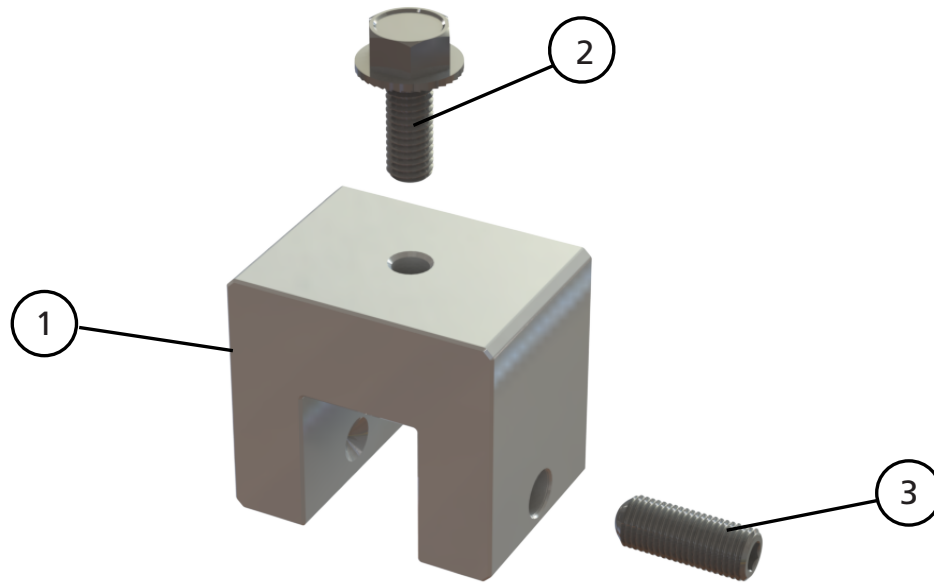

# Standing Seam PowerClamp



Part Number	Description
4000016	PowerClamp Set, Mini
4000017	PowerClamp Set, Standard

Item No.	Description	Part No.
1	PowerClamp, Mini (shown), Standard	4000710, 4000711
2	T-Bolt M8x20 mm Serrated Hex Head	4000614
3	Set Screw	N/A

## Technical data

	Standing Seam PowerClamp
Roof Type	Standing seam
Material	6061-T6 Aluminum
Finish	Mill
Roof Connection	Clamp
Torque	22 GA: 130-140 in/lbs 24 GA: 150-160 in/lbs 26 GA: 170-180 in/lbs 29 GA: 190-200 in/lbs
Compatibility	CrossRail 48-X, 48-XL, 80
Warranty	25 years