

# Yeti Clamp

## QUICK GUIDE

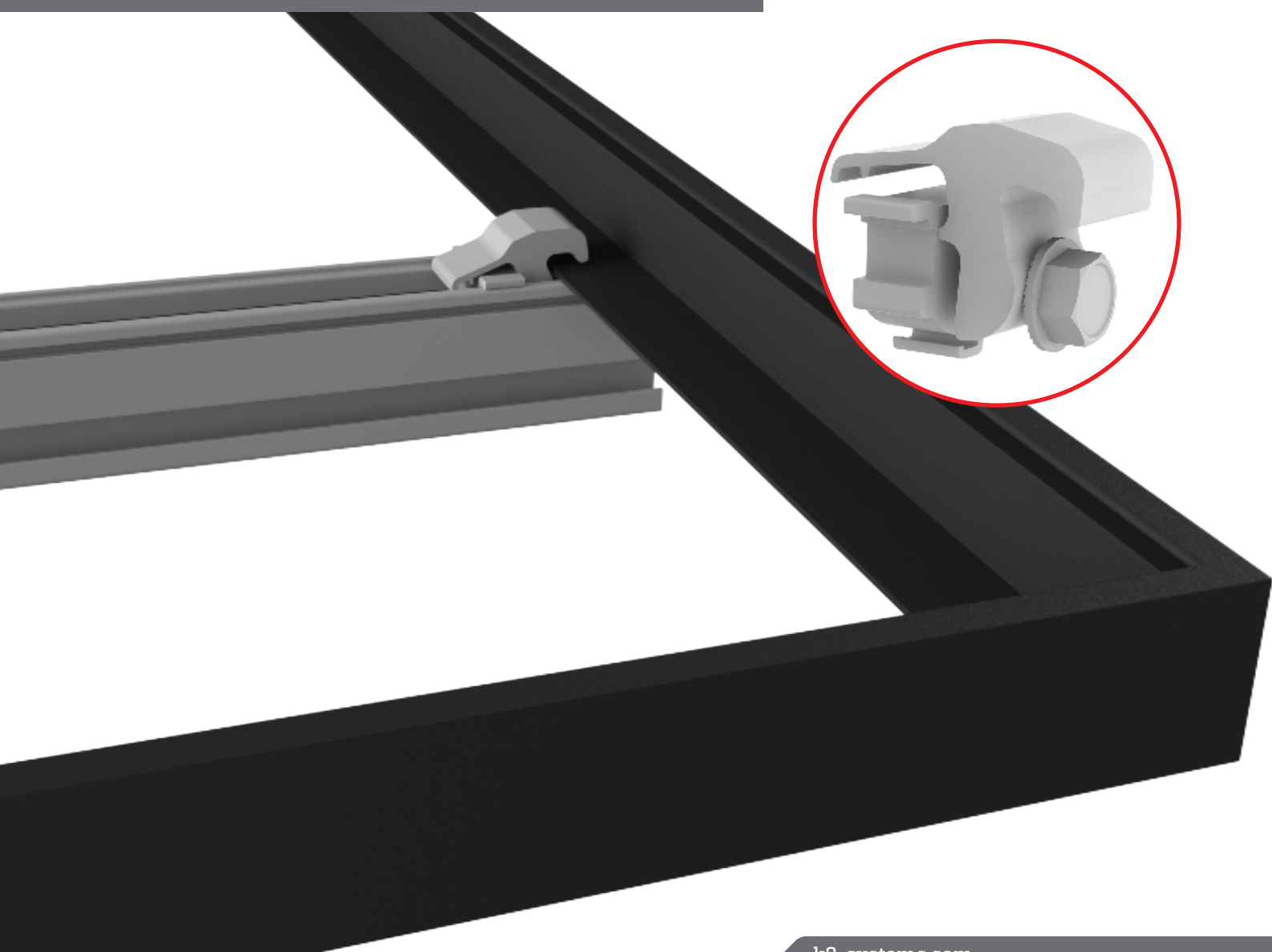

# Components



Part Number	Description
4000050-H	Yet Hidden EC for CrossRail, 13 mm Hex



## Tools overview



10-50 ft-lb  
[6 - 35 Nm]



13 mm dep socket  
▶ Torque 11.8 ft-lbs

## Important note

The Yeti Clamp must be installed in an array. It cannot be installed on a single module that is not connected to the array by a mid clamp.

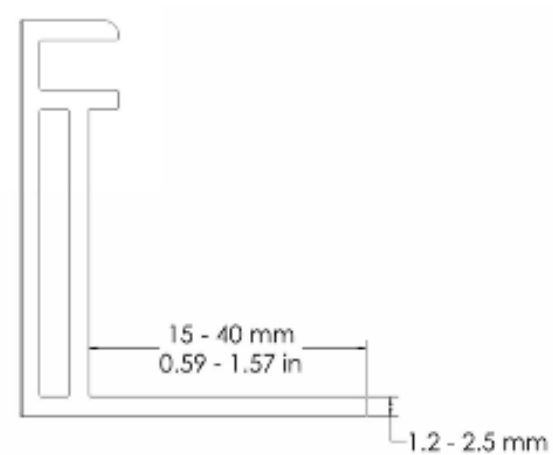

Frame Compatibility:  
Flange Thickness = 1.2 - 2.5 mm  
Flange Width = 15 - 40 mm

# Assembly



1



The Yeti Clamp comes preassembled and ready to install.  
Push the zip tie up into the leash channel located at the bottom of the Yeti Clamp.  
The zip tie is used as an optional leash. It is not required, but acts as an installation aid.

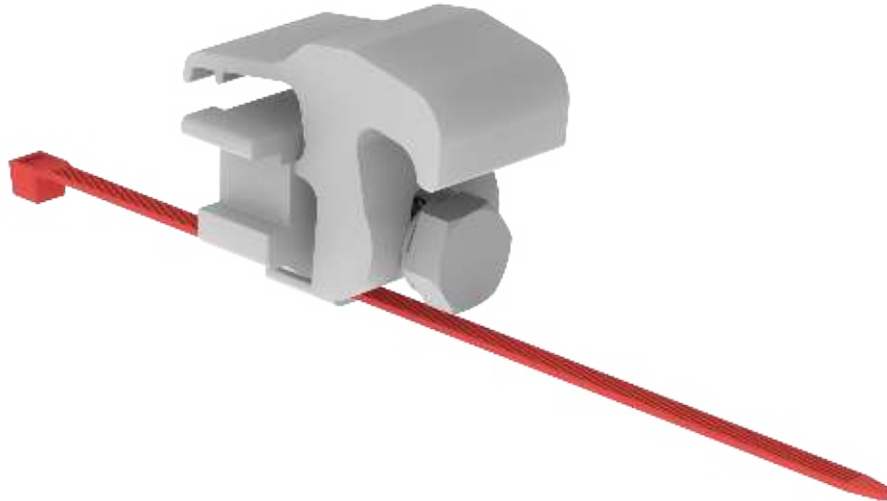

2



With the leash installed,  
slide the clamp into the rail  
channel with the bolt facing  
outward.

Slide the clamp into the rail  
leaving enough room for the  
module to be placed.

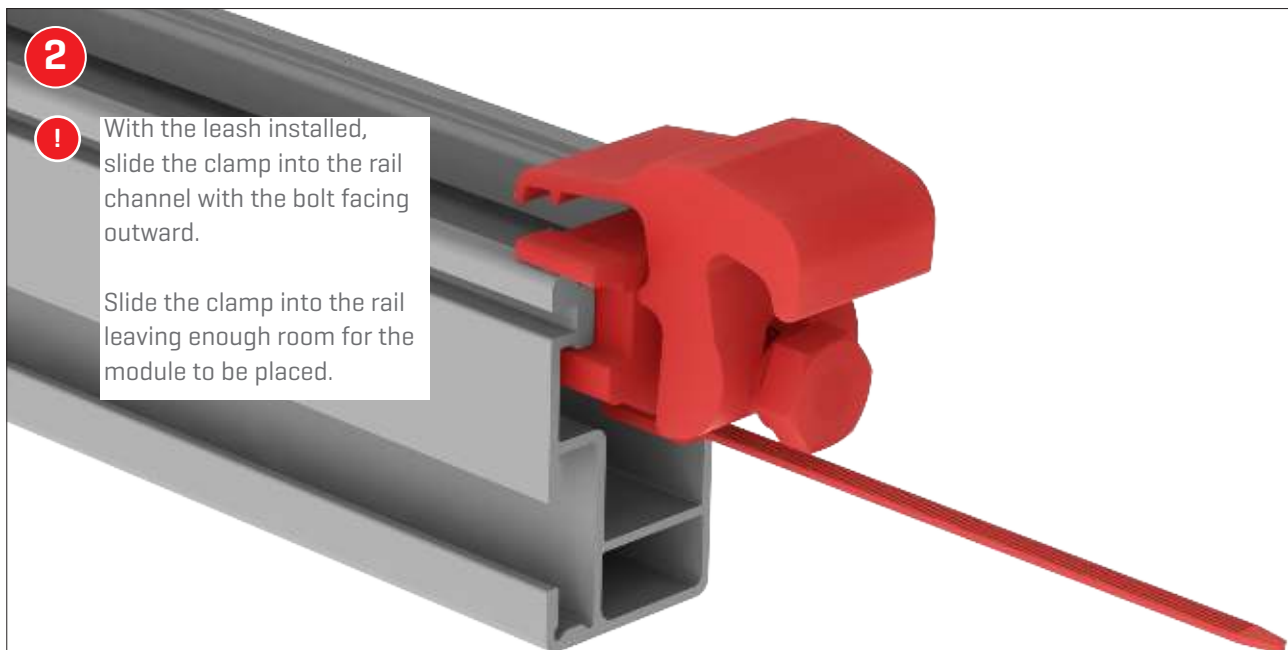

3



Place the module flush to the end of the rail.  
Pull the leash toward you so that the clamp slides over the module frame.

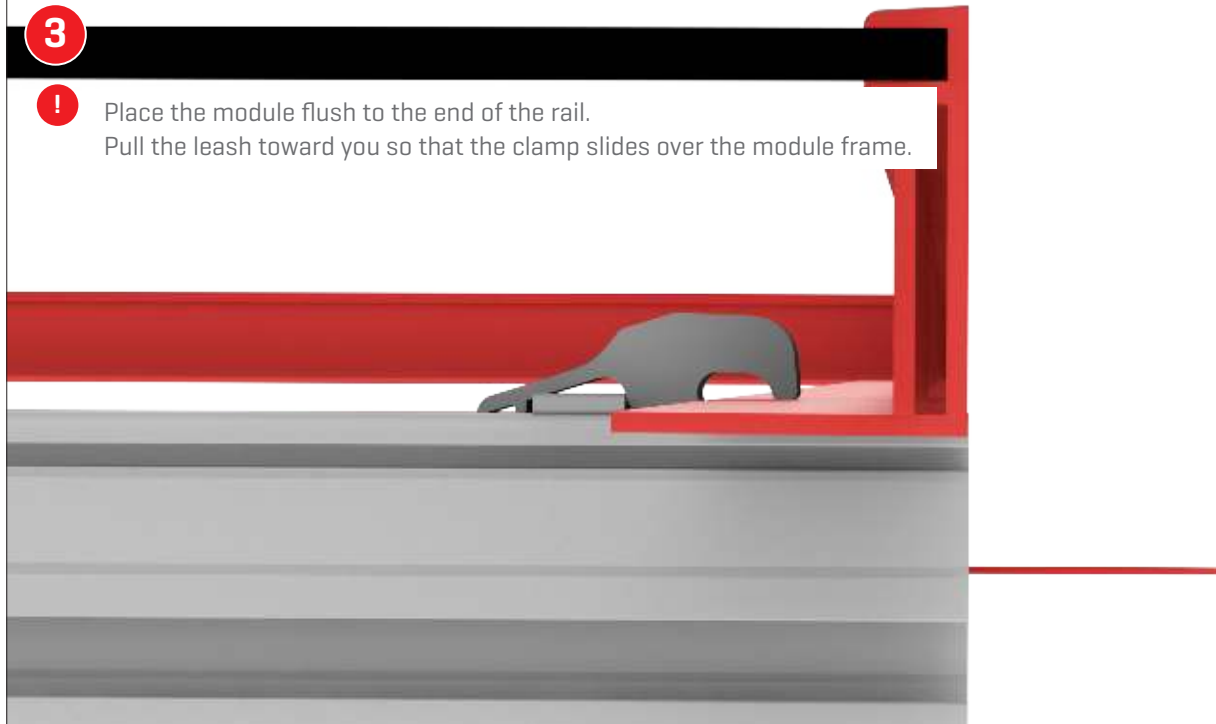

4



Using a torque wrench or standard drill with an HW6 Allen Drive, pull the clamp towards you and tighten the bolt.  
Do not use an impact drill.  
Torque: 12 ft-lbs

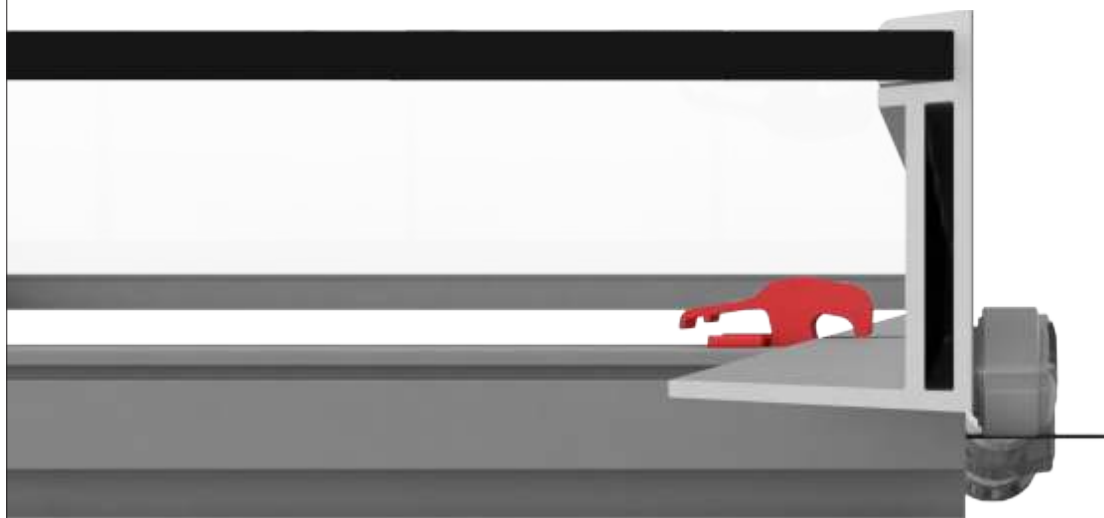

5



Be sure that the module is properly fastened with the Yeti Clamp.  
The inside edge of the module frame flange must be fully engaged with the Yeti Clamp as shown in the image.

6



Install end cap to create a flush, clean look!

